

Dimensional Documentation

viega

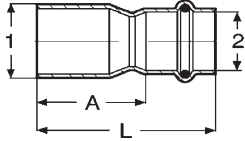

Viega ProPress Reducer Copper FTG x P - Model 2915.1

Part No.	Size		A (in)	L (in)
	1	2		
78077	3/4"	1/2"	1.42	2.17
78082	1"	1/2"	1.69	2.44
78087	1"	3/4"	1.42	2.32
22333	1 1/4"	1/2"	1.89	2.64
78092	1 1/4"	3/4"	1.85	2.76
78097	1 1/4"	1"	1.58	2.48
14543	1 1/2"	3/4"	2.56	3.47
78102	1 1/2"	1"	2.28	3.19
78107	1 1/2"	1 1/4"	2.04	3.07
78112	2"	1"	3.03	3.94
78117	2"	1 1/4"	2.79	3.82
78122	2"	1 1/2"	2.63	4.06

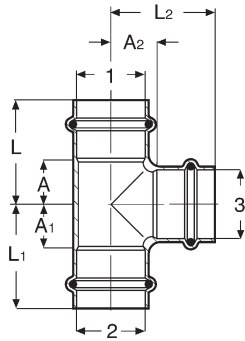

Viega ProPress Tee Copper P x P x P - Model 2918

Part No.	Size			A (in)	A1 (in)	A2 (in)	L (in)	L1 (in)	L2 (in)
	1	2	3						
77377	1/2"			0.75	0.75	0.50	1.50	1.50	1.25
77382	1/2"	1/2"	3/4"	0.91	0.91	0.59	1.65	1.65	1.50
15493	1/2"	1/2"	1"	1.10	1.10	0.55	1.85	1.85	1.46
77387	3/4"			0.85	0.85	0.59	1.75	1.75	1.50
77392	3/4"	1/2"	1/2"	0.69	0.98	0.63	1.59	1.73	1.38
77397	3/4"	1/2"	3/4"	0.85	1.14	0.59	1.75	1.89	1.50
77402	3/4"	3/4"	1/2"	0.69	0.69	0.63	1.59	1.59	1.38
77407	3/4"	3/4"	1"	0.97	0.97	0.63	1.87	1.87	1.54
77412	1"			0.97	0.97	0.79	1.87	1.87	1.69
22263	1"	1/2"	3/4"	0.85	1.24	0.75	1.76	1.99	1.66
94767	1"	1/2"	1"	0.97	1.52	0.79	1.87	2.26	1.69
77417	1"	3/4"	1/2"	0.69	0.89	0.79	1.59	1.79	1.54
77422	1"	3/4"	3/4"	0.85	1.04	0.75	1.75	1.95	1.65
77427	1"	3/4"	1"	0.97	1.18	0.78	1.87	2.07	1.69
77432	1"	1"	1/2"	0.69	0.69	0.79	1.59	1.59	1.54
77437	1"	1"	3/4"	0.85	0.85	0.75	1.75	1.75	1.65
15488	1"	1"	1 1/4"	1.16	1.16	0.84	2.07	2.07	1.87
77442	1 1/4"			1.02	1.02	0.86	2.05	2.05	1.89
22253	1 1/4"	1/2"	1 1/4"	1.02	1.77	0.87	2.05	2.52	1.89
22243	1 1/4"	3/4"	1/2"	0.64	1.13	0.93	1.68	2.03	1.68
22258	1 1/4"	3/4"	3/4"	0.76	1.30	0.87	1.80	2.21	1.78
22268	1 1/4"	3/4"	1"	0.88	1.40	0.91	1.91	2.31	1.82
22248	1 1/4"	3/4"	1 1/4"	1.02	1.54	0.86	2.05	2.45	1.89
22238	1 1/4"	1"	1/2"	0.64	0.91	0.93	1.68	1.82	1.68
94762	1 1/4"	1"	3/4"	0.76	1.14	0.87	1.79	2.05	1.77
14568	1 1/4"	1"	1"	0.88	1.28	0.91	1.91	2.19	1.81
94757	1 1/4"	1 1/4"	1/2"	0.65	0.65	0.93	1.67	1.67	1.67
77452	1 1/4"	1 1/4"	3/4"	0.77	0.77	0.89	1.79	1.79	1.77
77447	1 1/4"	1 1/4"	1"	0.88	0.88	0.90	1.91	1.91	1.81
77457	1 1/2"			1.13	1.13	1.13	2.56	2.56	2.56

Continued on next page