

# End Caps



## Features

- High tensile and impact strength
- Easy to install slip fit

## Applications

- Cap off pipe openings; allows access for future expansions or service
- Capping provides a finished look and inhibits damage from moisture and other elements

## Standard Material

- PVC

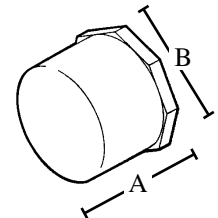

Catalog Number	UPC	Size	Ship Case	Weight/Case	Inches	
					A	B
<b>1081</b>	23407	<b>1/2"</b>	100	2	1	1.0625
<b>1082</b>	23091	<b>3/4"</b>	100	4	1.25	1.3125
<b>1083</b>	23092	<b>1"</b>	50	4	1.4375	1.625
<b>1084</b>	23093	<b>1-1/4"</b>	25	2	1.50	2
<b>1085</b>	23094	<b>1-1/2"</b>	25	3	1.625	2.25
<b>1086</b>	23095	<b>2"</b>	50	8	1.75	2.75
<b>1087</b>	23096	<b>2-1/2"</b>	25	7	2.125	3.50
<b>1088</b>	23097	<b>3"</b>	25	13	2.25	4
<b>1089</b>	23098	<b>3-1/2"</b>	25	15	2.3125	4.625
<b>1090</b>	23099	<b>4"</b>	25	19	2.50	5.0625
<b>1090A</b>	23102	<b>5"</b>	25	12	2.50	6.125
<b>1090B</b>	23101	<b>6"</b>	10	19	3.3125	7.25