

# Compression Lugs

## One Hole - Long Barrel

### Features

- Produced from high conductivity copper tubing and suitable for heavy duty applications
- Tin-plated to provide corrosion resistance
- Color coded

### Applications

- Listed for 35 KV maximum when properly installed
- Ideal for direct burial in earth or concrete and grounding applications

### Standard Material

- Copper

### Standard Finish

- Tin plated

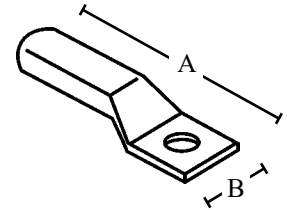

Catalog Number	UPC	Wire Size	Color Code	Bolt Size	Unit Carton	Ship Case	Weight/Case	Inches	
								A	B
<b>3001</b>	41050	<b>#8</b>	Red	<b>1/4"</b>	100	1000	16	1.70	.38
<b>3002</b>	41051	<b>#6</b>	Blue	<b>1/4"</b>	100	1000	20	1.77	.38
<b>3003</b>	41052	<b>#4</b>	Gray	<b>1/4"</b>	100	1000	23	1.77	.50
<b>3005</b>	41054	<b>#2</b>	Brown	<b>3/8"</b>	50	500	18	2.00	.67
<b>3005A</b>	81808	<b>#1</b>	Green	<b>3/8"</b>	50	500	23	2.09	.67
<b>3006</b>	41055	<b>1/0</b>	Pink	<b>3/8"</b>	50	500	29	2.20	.75
<b>3007</b>	41056	<b>2/0</b>	Black	<b>3/8"</b>	25	250	20	2.80	.75
<b>3008</b>	41057	<b>3/0</b>	Orange	<b>3/8"</b>	25	250	25	2.80	.87
<b>3008A</b>	81809	<b>3/0</b>	Orange	<b>1/2"</b>	25	250	23	2.80	.87
<b>3009</b>	41058	<b>4/0</b>	Purple	<b>1/2"</b>	25	250	28	2.80	1
<b>3009A</b>	41059	<b>250 MCM</b>	Yellow	<b>1/2"</b>	20	200	30	3.03	1.13
<b>3009B</b>	41061	<b>300 MCM</b>	White	<b>1/2"</b>	10	100	20	3.39	1.13
<b>3010</b>	41062	<b>350 MCM</b>	Red	<b>1/2"</b>	10	100	24	3.50	1.13
<b>3010A</b>	83541	<b>400 MCM</b>	Blue	<b>1/2"</b>	10	100	30	3.74	1.34
<b>3011</b>	41063	<b>500 MCM</b>	Brown	<b>1/2"</b>	5	50	23	4.02	1.50
<b>3011A</b>	41064	<b>600 MCM</b>	Green	<b>5/8"</b>	5	50	29	4.25	1.75
<b>3012</b>	41066	<b>750 MCM</b>	Black	<b>5/8"</b>	5	50	41	5.16	1.87