



RP17

Parts List
02-October-2017



*This parts list is current as of the above revision date.
See <http://www.rheempartslists.net/92-42800-RP17.pdf> for the current revision.*

Heat Pumps

No.	Notes	MODEL COOLING CAPACITY VARIATION	RP17 24 AJVCA	RP17 36 AJVCA	RP17 48 AJVCA	RP17 60 AJVCA
ELECTRICAL/FAN GROUP						
20	Stk	Fan Motor	51-102008-30	51-102008-30	51-102008-31	51-102008-29
21	Stk	Fan Blade	70-102345-08	70-102345-10	70-102345-09	70-102345-14
22		Ground Lug	45-19000-05	45-19000-05	45-19000-05	45-19000-05
23	Stk	Capacitor - Fan	43-101666-65	43-101666-65	43-101666-65	43-101666-65
23a		Capacitor Strap	AE-104562-01	AE-104562-01	AE-104562-01	AE-104562-01
24a	Stk	Variable Speed Control Board - EcoNet	47-104848-01	47-104848-01	47-104848-01	47-104848-01
		Control - Identity EEPROM (before W2016)	47-102738-109	47-102738-110	47-102738-111	47-102738-112
		Control - Identity EEPROM (on or after W2016)	47-102738-122	47-102738-123	47-102738-124	47-102738-125
24b	Stk	EMI Filter Board	47-105222-01	47-105222-01	47-105222-01	47-105222-01
24c	Stk	Power Inverter Board	47-105221-01	47-105221-01	47-105221-02	47-105221-03
24d		Choke	46-105466-01	46-105466-01	46-105466-02	46-105466-03
24e		Terminal Block	45-23222-02	45-23222-02	45-23222-02	45-23222-02
24f		Locking Wing Push Mount Tie	64-25340-02	64-25340-02	64-25340-02	64-25340-02
24g		Universal Bushing	45-103252-02	45-103252-02	45-103252-02	45-103252-02
26		Double Ground Lug	45-19000-05	45-19000-05	45-19000-05	45-19000-05
27	Stk	Low Pressure Transducer	47-103454-05	47-103454-05	47-103454-05	47-103454-05
27a		Valve Body - Low Pressure Control	61-18542-01	61-18542-01	61-18542-01	61-18542-01
28	Stk	High Pressure Control	47-103669-04	47-103669-04	47-103669-04	47-103669-04
	Stk	Discharge Sensor	47-102710-18	47-102710-18	47-102710-18	47-102710-18
	Stk	Sensor/Clip Assembly (Compressor Sump Sensor)	47-102710-12	47-102710-12	47-102710-22	47-102710-22
	Stk	Sensor/Clip Assembly - 2 Sensors (Coil Sensor)	47-102710-11	47-102710-11	47-102710-11	47-102710-23
	Stk	Ambient Sensor	47-102709-06	47-102709-06	47-102709-06	47-102709-06
	Stk	Pressure Transducer	47-103454-05	47-103454-05	47-103454-05	47-103454-05
		Wire Harness - Pressure Transducer (SPT)	45-104130-03	45-104130-03	45-104130-03	45-104130-03
		Wire Harness - Control Board	45-104991-01	45-104991-01	45-104991-01	45-104991-01
		Wire Harness - Filter to Inverter	45-104991-02	45-104991-02	45-104991-03	45-104991-03
		Wire Harness - Terminal Block to Filter	45-104991-04	45-104991-04	45-104991-04	45-104991-04

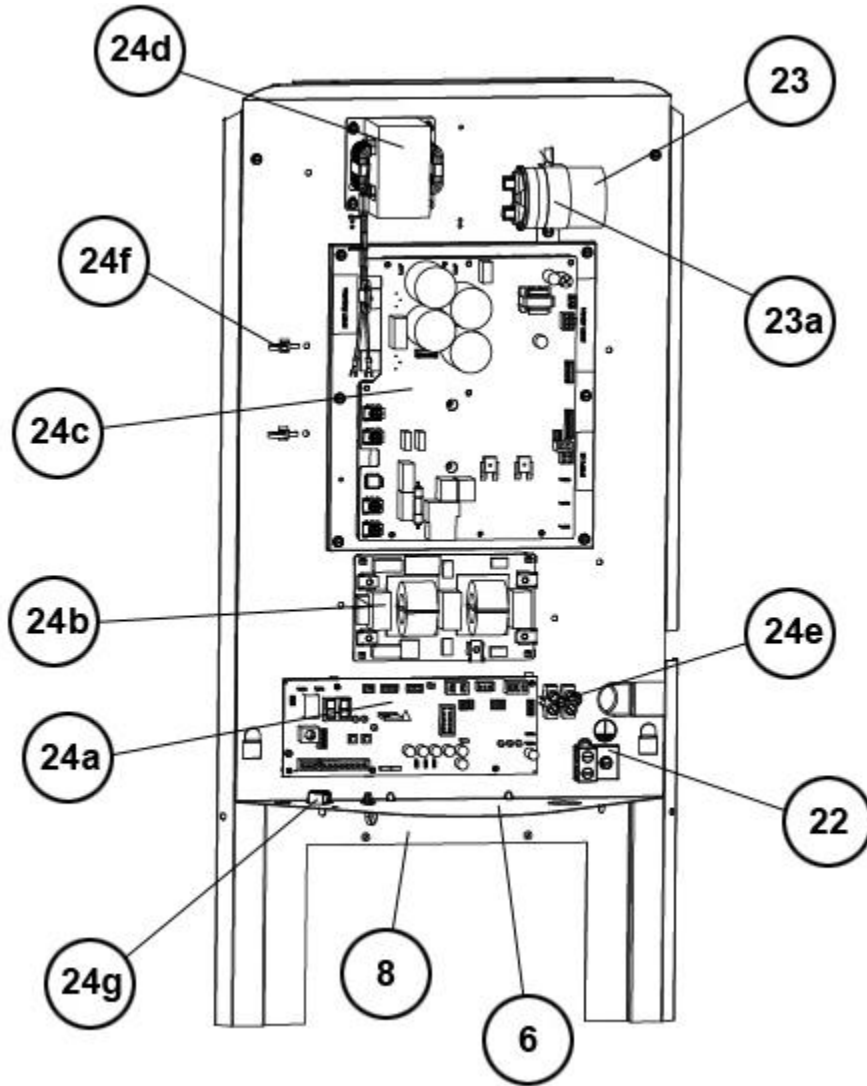

Control Box