



4700 W. 160<sup>th</sup> St.  
 Cleveland, OH 44135  
 PH:800-321-9532  
 FX:800-321-9535  
 www.oatey.com  
 TECHNICAL SPECIFICATION

## DuoFit™ PIPE SUPPORT



**TECHNICAL SPECIFICATION:** Oatey DuoFit Pipe Support with Nail provides fast and easy installation for 1/2" and 3/4" copper tube size (CTS) piping with one clamp. DuoFit Pipe Support with Nail can eliminate contact between the pipe and framing surface and insulate against sound. DuoFit Pipe Support can be used with hydronic heating systems.

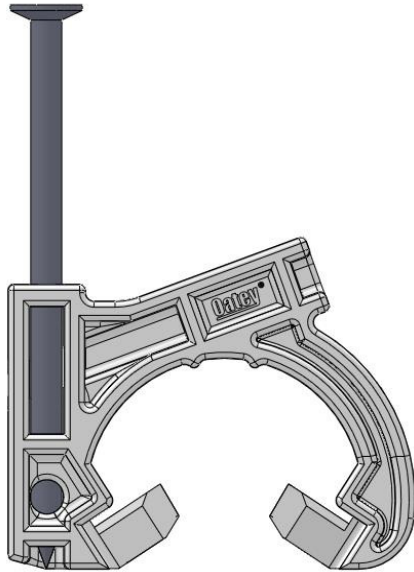

### APPROVALS AND LISTINGS



IAPMO Listed

### PHYSICAL/CHEMICAL PROPERTIES

Material	Polypropylene
Color	Black
Temperature Range	0°F to 230°F

### DIRECTIONS FOR USE

Open clamp and snap over tube or piping. Slide into position. Hammer into place. Move nail to alternative slot to keep pipe off the stud. Barbed shank nail will set clamp and ridges will hold securely. Check with local codes to ensure proper spacing requirements for piping support.

### COMMON APPLICATIONS

Oatey DuoFit Pipe Clamps provide fast and easy installation and support for all types of piping including copper, CPVC, and PEX

*Patent Pending.*

PRODUCT NUMBER	DESCRIPTION	PACK	CARTON WEIGHT
34285	1/2"-3/4" DuoFit Pipe Support System with Nail (100 per polybag)	500	7 lbs.
34295	1/2"-3/4" DuoFit Pipe Support System with Nail (12 per polybag)	6 bags	1 lbs.
34297	1/2"-3/4" DuoFit Pipe Support System with Nail (400 in 2 Gallon Bucket)	1	