

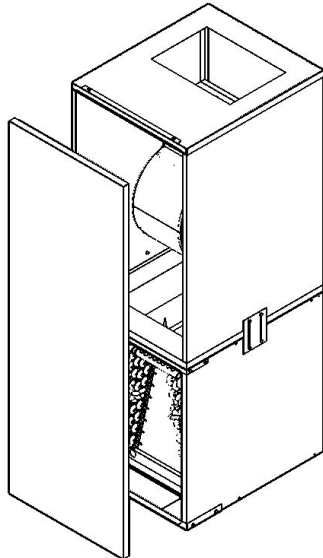

## PRODUCT DIMENSIONS & SPECIFICATIONS

# AEU/AED UPFLOW/DOWNFLOW CONVERTIBLE MANUFACTURED HOME ELECTRIC FURNACE KIT



AEU - Upflow Configuration

Representative images only. Some models may vary in appearance. Due to continuous product improvement, specifications are subject to change without notice.

Note: coil not included.

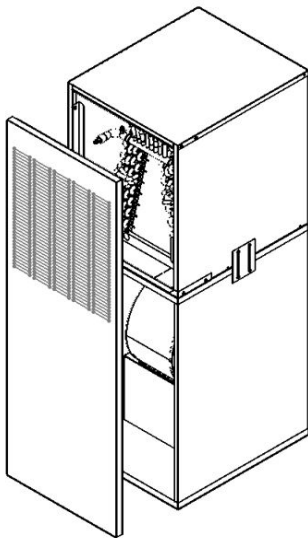

AED-001 Downflow - Front Return Configuration  
(top and front return also available)

### FEATURES AND BENEFITS

#### APPLICATION VERSATILITY

Designed for the manufactured home market with flexibility in mind. One-piece air handler with the ability to be factory built as upflow (solid door) or downflow (louvered door) air handler. Can also be field configured to opposite configuration with no additional parts or kits. 2 – 5 tons of cooling or heating airflow with a range of electric heat kits.

#### MOTOR

Constant torque ECM speeds and torques are controlled by software embedded in the motor to maintain constant torque. Motors are pre-programmed at the factory. Direct drive blowers circulate air quietly and efficiently. Motor speeds and torques programmed in the motor. Blowers mounted on rails so they can be easily removed for service.

#### CABINET

Sturdy, galvanized steel cabinet with painted front panels. Cabinet fully insulated with 1/2" micro mat non-hygroscopic insulation to prevent sweating and mold growth, to encapsulate glass fibers, and to provide excellent R-value. Stick pins ensure insulation remains in place.

#### MODULAR ELECTRIC HEAT KITS

Heat kits available with either circuit breakers or terminal blocks. Available from 3 to 20 KW. Models with electric heat include sequencers and temperature limit switches for safe, efficient operation. Modules are easily installed in the field using molex plugs or can be ordered factory-installed. Controls are accessible from the front for easy service. Disconnect does not protrude through the wall panel.

#### ELECTRONIC CIRCUIT BOARD

Electronic circuit board provides 30 secs ON/OFF blower time delay extracting more heat/cool from the coil. Automotive pull-style fuse integrated into board.

#### WARRANTY

Hassle-free five-year limited parts warranty.

#### OPTIONS

See options menu.

Phone: 281.441.6500  
Toll Free: 800.423.9007  
Fax: 281.441.6510  
[www.aspenmfg.com](http://www.aspenmfg.com)



\* For complete warranty details visit [www.aspenmfg.com](http://www.aspenmfg.com).

Revised 12/06/22. In keeping with its policy of continuous progress and product improvement, Aspen reserves the right to make changes without notice and incurring obligation. © 2022

# ELECTRIC FURNACE

## HEATING AND COOLING PERFORMANCE AND ELECTRICAL DATA

MODEL	HEAT KIT	PERFORMANCE DATA				ELECTRICAL DATA				
		NOMINAL COOLING (BTUS)	HEATING (KW)		HEATING (KBTUH)		MINIMUM CIRCUIT AMPACITY (MCA)		MAX BREAKER OR FUSE SIZE	
			208V	240V	208V	240V	208V	240V	208V	240V
AE(U/D)	F(C,T)L00	24,000 - 60,000	0	0	0	0	6.8	6.8	15	15
	F(C,T)L03		2.3	3	7.8	10.2	20.3	22.4	25	25
	F(C,T)L05		3.6	4.8	12.6	16.4	28.4	31.8	30	35
	F(C,T)L08		6	8	20.4	27.3	42.8	48.4	45	50
	F(C,T)L10		7.2	9.6	24.5	32.8	50	56.8	50	60
	F(C,T)L15		11.3	14.4	38.5	49.1	50/21.6	56.8/25	50/25	60/25
	F(C,T)L20		14.4	19.2	49.1	65.5	50/43.3	56.8/50	50/45	60/50

## BLOWER DATA

MODEL	SPEED TAP	MOTOR HP	MOTOR AMPS	MOTOR VOLTAGE	CFM V. EXTERNAL STATIC *				
					0.10	0.20	0.30	0.40	0.50
AE(U/D)	T1	3/4	5.4	240	940	850	795	740	640
	T2				1155	1070	1015	950	885
	T3				1375	1305	1255	1180	1127
	T4				1500	1430	1375	1315	1260
	T5				1850	1800	1760	1710	1650

## AIR HANDLER CHASSIS NOMENCLATURE

AE(U/D)	-001
AE(U/D) = 240V Constant torque ECM Manufactured Housing Electric Furnace	Option Code

## ELECTRIC HEAT KIT NOMENCLATURE

F	C	L	03
Electric Heat	<u>Interruption</u> C = Circuit Breaker T = Terminal Block P = Circuit Breaker w/Single Point 3 = 3-Phase Circuit Breaker 4 = 3-Phase Terminal Block	L	<u>Heat Strip</u> 00 = 0 KW 03 = 3 KW 05 = 5 KW 08 = 8 KW 10 = 10 KW 15 = 15 KW 20 = 20 KW

# DIMENSIONS

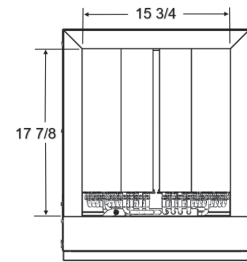
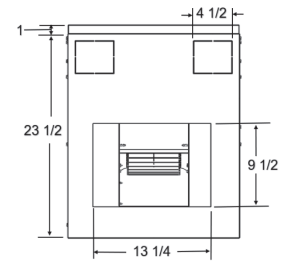
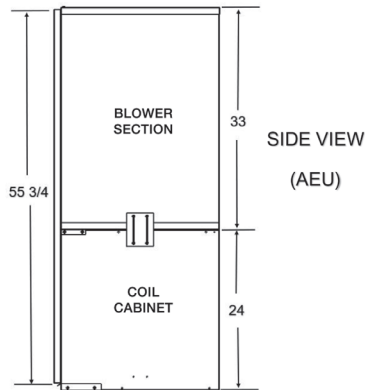
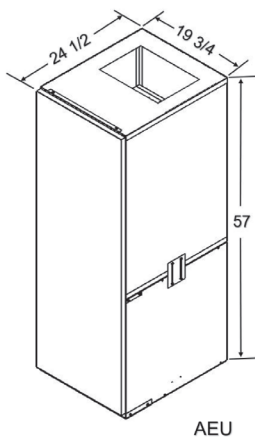
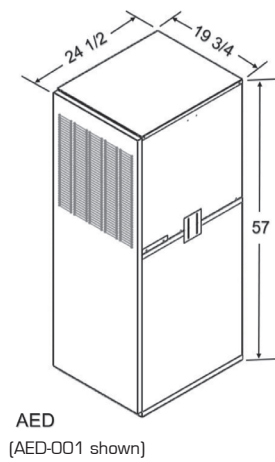

DOWNFLOW



UPFLOW

Note: Coil not included. The air handler is designed to work exclusively with the Aspen CM coil line.

MODEL	"CONFIGURATION (DEFAULT)"	"RETURN (DEFAULT)"	"DOOR (DEFAULT)"	CONVERTIBLE TO	KIT NEEDED FOR CONVERSION
AEU-000	UPFLOW	BOTTOM	SOLID	AED-000 (DOWNFLOW/TOP RETURN)	"NONE"
				AED-001 (DOWNFLOW/FRONT RETURN)	AEDK-01
				AED-002 (DOWNFLOW/TOP&FRONT RETURN)	AEDK-02
AED-000	DOWNFLOW	TOP	SOLID	AEU-000 (UPFLOW/BOTTOM RETURN)	"NONE"
				AED-001 (DOWNFLOW/FRONT RETURN)	AEDK-01
				AED-002 (DOWNFLOW/TOP&FRONT RETURN)	AEDK-02
AED-001	DOWNFLOW	FRONT	LOUVERED	AEU-000 (UPFLOW/BOTTOM RETURN)	AEDK-03
				AED-000 (DOWNFLOW/TOP RETURN)	AEDK-03
				AED-002 (DOWNFLOW/TOP&FRONT RETURN)	AEDK-04
AED-002	DOWNFLOW	TOP & FRONT	LOUVERED	AEU-000 (UPFLOW/BOTTOM RETURN)	AEDK-05
				AED-000 (DOWNFLOW/TOP RETURN)	AEDK-06
				AED-001 (DOWNFLOW/FRONT RETURN)	AEDK-07



Phone: 281.441.6500  
 Toll Free: 800.423.9007  
 Fax: 281.441.6510  
[www.aspenmf.com](http://www.aspenmf.com)

SHIPPING SPECIFICATIONS	
SKID QTY	SHIP WEIGHT (LB)
4	115